

BOLT ANCHOR SHACKLE WITH OVERSIZE BOLT

316-NM STAINLESS STEEL



Import



Drop
Forged



Load
Rated



Suncor
Exclusive

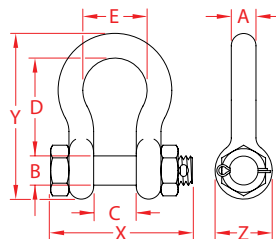

ITEM	A (size)	B	C	D	E	X (height)	Y (length)	Z (width)	WLL (lb)	WT (lb)	PACKAGING TYPE	EACH (qty)	INNER (qty)	CARTON (qty)	UPC
S0116-SA07	1/4"	0.31"	0.47"	1.11"	0.75"	1.66"	1.79"	0.61"	1,000	0.12	POLYBAG	1	10	200	791506030591
S0116-SA08	5/16"	0.38"	0.53"	1.20"	0.80"	1.81"	2.07"	0.74"	1,300	0.18	POLYBAG	1	10	100	791506030614
S0116-SA10	3/8"	0.44"	0.66"	1.41"	1.00"	2.24"	2.40"	0.89"	1,500	0.32	POLYBAG	1	10	100	791506030638
S0116-SA12	7/16"	0.50"	0.72"	1.77"	1.10"	2.65"	2.92"	1.01"	2,000	0.47	POLYBAG	1	1	50	791506030652
S0116-SA13	1/2"	0.63"	0.82"	1.83"	1.20"	2.86"	3.21"	1.16"	3,000	0.76	POLYBAG	1	1	25	791506030676
S0116-SA16	5/8"	0.75"	1.02"	2.41"	1.60"	3.67"	4.21"	1.46"	4,000	1.45	POLYBAG	1	1	20	791506030690
S0116-SA20	3/4"	0.88"	1.25"	2.84"	1.90"	4.21"	4.92"	1.73"	6,000	2.42	POLYBAG	1	1	15	791506030713
S0116-SA22	7/8"	1.00"	1.48"	3.30"	2.20"	4.85"	5.73"	1.94"	8,000	3.66	POLYBAG	1	1	10	791506030737
S0116-SA25	1"	1.13"	1.70"	3.80"	2.60"	5.15"	6.46"	2.20"	10,000	5.09	POLYBAG	1	1	5	791506030751
S0116-SA32	1-1/4"	1.38"	2.03"	4.69"	3.20"	7.22"	8.15"	2.77"	14,000	10.79	POLYBAG	1	1	2	791506030775

NOTE:

I/A/W FED SPEC RR-C-271, TYPE IVA, CLASS 3, EXCEPT 316 STAINLESS. MEETS THE REQUIREMENTS OF: MIL-DTL-32655. MEETS ASME B30.26-2010 SECTION 26-0. MARKED TO THE NEAREST FRACTIONAL TON.

ALL DIMENSIONS ARE NOMINAL (+/- 3%) AND ARE SUBJECT TO CHANGE WITHOUT NOTICE.