

SPRING CLIP W/ EYE - KEY LOCK

316 STAINLESS STEEL



Import



Wire
Formed



Load
Rated

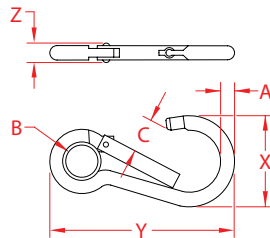

ITEM	A	B	C	X (height)	Y (length)	Z (width)	WLL (lb)	WT (lb)	PACKAGING TYPE	EACH (qty)	INNER (qty)	CARTON (qty)	UPC
S0121-K050	3/16"	0.24"	0.29"	0.98"	2.00"	0.19"	200	0.04	POLYBAG	1	10	1000	791506031079
S0121-K060	1/4"	0.27"	0.37"	1.20"	2.38"	0.23"	250	0.07	POLYBAG	1	10	500	791506031086
S0121-K070	9/32"	0.35"	0.40"	1.35"	2.88"	0.27"	300	0.10	POLYBAG	1	10	250	791506031093
S0121-K080	5/16"	0.39"	0.43"	1.53"	3.25"	0.31"	400	0.16	POLYBAG	1	5	200	791506031109
S0121-K100	3/8"	0.45"	0.66"	1.94"	4.00"	0.38"	600	0.30	POLYBAG	1	5	100	791506031116
S0121-K120	7/16"	0.59"	0.70"	2.19"	4.75"	0.43"	800	0.43	POLYBAG	1	1	60	791506031123
S0121-K160	1/2"	0.87"	1.18"	3.17"	6.38"	0.52"	1,000	0.78	POLYBAG	1	1	25	791506031130

NOTE:

KEY LOCK MECHANISM. EACH CLIP IS PROOF TESTED AND STAMPED WITH THE BREAK LOAD. CLIPS S0121-K050 - S0121-K070 ARE MARKED IN KILOGRAMS (CONVERSION: KGX2.2=LB), WHILE S0121-K080 - S0121-K160 ARE MARKED IN KILONEWTONS (CONVERSION: KN X 224.8 = LB). ALL DIMENSIONS ARE NOMINAL (+/- 3%) AND ARE SUBJECT TO CHANGE WITHOUT NOTICE.