

JAW AND JAW SWIVEL

316 STAINLESS STEEL

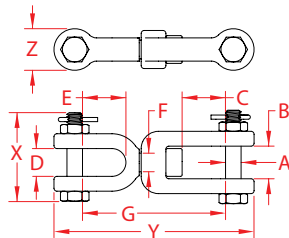

Import



Drop Forged



Suncor Exclusive



MIL-SPEC

ITEM	A	B	C	D	E	F	G	X (height)	Y (length)	Z (width)	WLL (lb)	WT (lb)	PACKAGING TYPE	EACH (qty)	INNER (qty)	CARTON (qty)	UPC
S0156-FS05	3/16"	0.53"	0.66"	0.44"	0.66"	0.25"	2.20"	1.67"	3.11"	0.65"	600	0.23	POLYBAG	1	5	150	791506034209
S0156-FS07	1/4"	0.60"	0.85"	0.50"	0.85"	0.31"	2.69"	1.85"	3.68"	0.75"	1,000	0.34	POLYBAG	1	5	100	791506034216
S0156-FS08	5/16"	0.66"	0.88"	0.56"	0.88"	0.38"	2.89"	2.00"	4.05"	0.88"	1,600	0.52	POLYBAG	1	1	50	791506034223
S0156-FS10	3/8"	0.85"	1.07"	0.63"	1.07"	0.50"	3.64"	2.57"	5.04"	1.05"	3,000	1.02	POLYBAG	1	1	25	791506034230
S0156-FS13*	1/2"	1.04"	1.42"	0.75"	1.42"	0.63"	4.55"	3.20"	6.31"	1.26"	4,400	1.89	POLYBAG	1	1	20	791506034247
S0156-FS16	5/8"	1.23"	1.50"	1.00"	1.50"	0.75"	5.11"	3.66"	7.34"	1.63"	6,000	3.33	POLYBAG	1	1	10	791506034254

NOTE:

MEETS THE REQUIREMENTS OF: MIL-DTL-32655 (*EXCLUDING S0156-FS13). SWIVELS ARE POSITIONING DEVICES AND ARE NOT INTENDED TO ROTATE UNDER LOAD.

MARKED WITH SIZE AND WORKING LOAD LIMIT.

ALL DIMENSIONS ARE NOMINAL (+/- 3%) AND ARE SUBJECT TO CHANGE WITHOUT NOTICE.