

HEAVY DUTY FORGED "D" RING

316 STAINLESS STEEL



Import



Drop
Forged

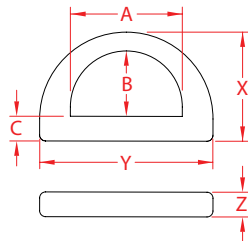

| ITEM | A (size) | B | C | X (height) | Y (length) | Z (width) | WLL (lb) | WT (lb) | PACKAGING TYPE | EACH (qty) | INNER (qty) | CARTON (qty) | UPC |
|-------------|-------------|-------|-------|---------------|---------------|--------------|-------------|------------|-------------------|---------------|----------------|-----------------|--------------|
| S0222-F025 | 1" | 0.65" | 0.25" | 1.10" | 1.75" | 0.25" | 1,200 | 0.06 | POLYBAG | 1 | 50 | 500 | 791506037507 |
| S0222-F038 | 1-1/2" | 0.87" | 0.31" | 1.47" | 2.31" | 0.31" | 2,000 | 0.13 | POLYBAG | 1 | 50 | 250 | 791506037514 |
| S0222-F050* | 2" | 1.10" | 0.38" | 1.86" | 3.03" | 0.38" | 4,000 | 0.24 | POLYBAG | 1 | 15 | 150 | 791506037521 |

NOTE:

MEETS THE REQUIREMENTS OF: MIL-DTL-32655 (*EXCLUDING S0222-F050).

WORKING LOAD IS BASED ON "A" LENGTH BEING USED IN FULL BY WEBBING, AND NOT UNDER POINT OR SHOCK LOAD.

ALL DIMENSIONS ARE NOMINAL (+/- 3%) AND ARE SUBJECT TO CHANGE WITHOUT NOTICE.