

CLEVIS SLIP HOOK

316 STAINLESS STEEL



Import



Drop Forged



Load Rated

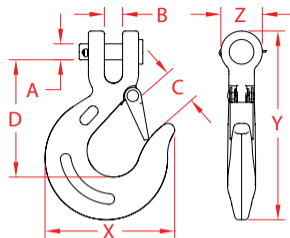

ITEM	SIZE	A	B	C	D	X (height)	Y (length)	Z (width)	WLL (lb)	WT (lb)	PACKAGING TYPE	EACH (qty)	INNER (qty)	CARTON (qty)	UPC
S0452-0007	1/4"	0.31"	0.41"	0.58"	2.59"	2.60"	4.06"	0.82"	1,000	0.66	POLYBAG	1	1	60	791506045250
S0452-0008	5/16"	0.37"	0.42"	0.83"	2.71"	2.90"	4.41"	0.98"	1,500	0.94	POLYBAG	1	1	40	791506045267
S0452-0010	3/8"	0.47"	0.56"	0.95"	3.23"	3.48"	5.21"	1.07"	2,000	1.35	POLYBAG	1	1	30	791506045274
S0452-0013	1/2"	0.54"	0.64"	1.05"	3.58"	4.15"	6.00"	1.25"	3,000	2.54	POLYBAG	1	1	15	791506045281

NOTE:

MEETS THE REQUIREMENTS OF: MIL-DTL-32655. MEETS ASME B30.10-2010. WORKING LOADS ARE BASED ON GRADUAL PULL, NOT SHOCK LOADS. INCLUDES REMOVABLE LATCH & CLEVIS PIN. LARGER WLL HOOK DESIGNS ARE IN PROCESS. PLEASE CALL FOR AVAILABILITY. ALL DIMENSIONS ARE NOMINAL (+/- 3%) AND ARE SUBJECT TO CHANGE WITHOUT NOTICE.