

WALL MOUNT TERMINAL, HAND SWAGE

316 STAINLESS STEEL



Import



Precision
Machined



Stamped

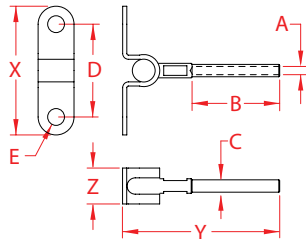

ITEM	A (wire)	B	C	D	E	X (height)	Y (length)	Z (width)	WT (lb)	PACKAGING TYPE	EACH (qty)	INNER (qty)	CARTON (qty)	UPC
S0723-H003	1/8"	1.51"	0.21"	1.62"	0.24"	2.16"	3.65"	0.59"	0.07	POLYBAG	1	25	500	791506048893
S0723-H005	3/16"	2.01"	0.30"	1.62"	0.24"	2.16"	3.32"	0.59"	0.09	POLYBAG	1	25	500	791506048909

NOTE:

DESIGNED FOR HAND SWAGE USE ONLY. THIS WALL MOUNTED SWAGE FITTING IS PERFECT FOR ARCHITECTURAL APPLICATIONS WHERE WIRE ROPE IS DESIRED. WALL MOUNT AND SWAGE FITTING ARE MADE FROM GRADE 316 STAINLESS STEEL. CRIMP THE HAND SWAGE STUDS ONTO THE WIRE ROPE USING THE HAND SWAGER (PART # E0113-H600). USE HAND SWAGER HOLE #1 ON 1/8" WIRE AND HOLE #2 ON 3/16" WIRE. ALL DIMENSIONS ARE NOMINAL (+/- 3%) AND ARE SUBJECT TO CHANGE WITHOUT NOTICE.