

HINGED TOP SLIDE

316 STAINLESS STEEL



Import



Precision
Cast



Suncor
Exclusive

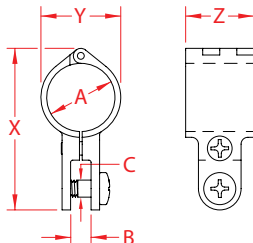

| ITEM | A | B | C | X (height) | Y (length) | Z (width) | WT (lb) | PACKAGING TYPE | EACH (qty) | INNER (qty) | CARTON (qty) | UPC |
|------------|------|-------|-------|---------------|---------------|--------------|------------|-------------------|---------------|----------------|-----------------|--------------|
| S3683-0000 | 7/8" | 0.30" | 0.25" | 2.27" | 1.04" | 1.00" | 0.15 | POLYBAG | 1 | 1 | 50 | 791506057161 |
| S3683-0001 | 1" | 0.30" | 0.25" | 2.41" | 1.17" | 1.00" | 0.15 | POLYBAG | 1 | 1 | 50 | 791506057178 |

NOTE:
VERY SLEEK DESIGN WITH INCORPORATED HINGE (NOT 2 PARTS) WHICH PREVENTS LOSS DURING INSTALLATION;
ALLOWS EASY INSTALLATION OF A TOP SLIDE ON ANY EXISTING BIMINI TOP.
ALL DIMENSIONS ARE NOMINAL (+/- 3%) AND ARE SUBJECT TO CHANGE WITHOUT NOTICE.