

SWAGE JAW

316 STAINLESS STEEL

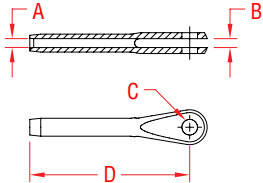

ITEM	A	B	C	D	BEFORE	AFTER	WT
	(wire)				(swage)	(swage)	(lb)
S0734-0001	1/16"	0.09"	0.19"	1.57"	0.160"	0.138"	0.01
S0734-0002	3/32"	0.11"	0.19"	1.95"	0.218"	0.190"	0.02
S0734-0003	1/8"	0.20"	0.19"	2.35"	0.250"	0.219"	0.03
S0734-0004	5/32"	0.20"	0.25"	2.66"	0.297"	0.250"	0.05
S0734-0005	3/16"	0.26"	0.31"	3.07"	0.359"	0.313"	0.09
S0734-0006	7/32"	0.30"	0.31"	3.44"	0.427"	0.375"	0.13
S0734-0007	1/4"	0.31"	0.38"	3.81"	0.494"	0.438"	0.21
S0734-0009	5/16"	0.35"	0.44"	4.44"	0.635"	0.563"	0.40
S0734-0010	3/8"	0.38"	0.50"	5.33"	0.703"	0.625"	0.62
S0734-0013	1/2"	0.47"	0.63"	6.94"	0.844"	0.750"	1.08

**NOTE: MACHINE SWAGE ONLY.
DESIGNED TO MATE WITH S0733-SERIES SWAGE EYES (ABOVE).**