

QA™ STUD & TOGGLE

316 STAINLESS STEEL

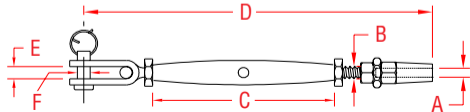

ITEM	A	B	C	D	E	F	WT
	(wire size)	(thread)					(lb)
S0764-0703	1/8"	1/4"	4.20"	7.25"	0.35"	0.23"	0.25
S0764-0704	5/32"	1/4"	4.20"	7.50"	0.35"	0.23"	0.27
S0764-0904	5/32"	5/16"	4.40"	8.00"	0.40"	0.31"	0.44
S0764-0905	3/16"	5/16"	4.40"	8.31"	0.40"	0.31"	0.50
S0764-1005	3/16"	3/8"	4.90"	9.25"	0.56"	0.37"	0.64
S0764-1007	1/4"	3/8"	4.90"	9.75"	0.56"	0.37"	0.74
S0764-1307	1/4"	1/2"	5.98"	11.00"	0.63"	0.48"	1.30
S0764-1309	5/16"	1/2"	5.98"	12.25"	0.63"	0.48"	1.54
S0764-1609	5/16"	5/8"	7.66"	15.00"	0.80"	0.63"	2.75
S0764-1610	3/8"	5/8"	7.66"	15.75"	0.80"	0.63"	2.95

NOTE: MECHANICAL SWAGE FITTING ALLOWS VERY FAST ATTACHMENT TO ANY TYPE OF CABLE (1X19, 7X19, OR 7X7) USING ONLY SIMPLE TOOLS. WLL IS DETERMINED BY WLL OF WIRE USED.