

TURNBUCKLE JAW & SWAGE

316 STAINLESS STEEL

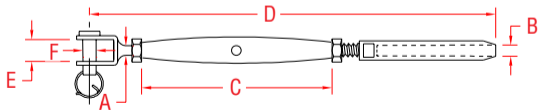

ITEM	A	B	C	D	E	F	WT
	(size)						(lb)
S0781-0703	1/4"	1/8"	4.20"	7.50"	0.38"	0.22"	0.19
S0781-0704	1/4"	5/32"	4.20"	7.75"	0.38"	0.22"	0.21
S0781-0705	1/4"	3/16"	4.25"	8.25"	0.38"	0.22"	0.23
S0781-0904	5/16"	5/32"	4.32"	8.19"	0.40"	0.30"	0.35
S0781-0905	5/16"	3/16"	4.32"	8.56"	0.40"	0.30"	0.37
S0781-1005	3/8"	3/16"	4.90"	9.25"	0.46"	0.37"	0.53
S0781-1007	3/8"	1/4"	4.90"	10.00"	0.46"	0.37"	0.60
S0781-1307	1/2"	1/4"	5.87"	11.87"	0.59"	0.46"	1.09
S0781-1309	1/2"	5/16"	5.87"	12.62"	0.59"	0.46"	1.21
S0781-1610	5/8"	3/8"	7.48"	15.00"	0.70"	0.55"	2.50
S0781-2013	3/4"	1/2"	8.66"	17.40"	0.94"	0.75"	4.20

NOTE:

OTHER CONFIGURATIONS ARE AVAILABLE. BODIES ONLY ON PAGE 23. THREADS ARE "UNF". MACHINE SWAGE ONLY.