

TOGGLE & HAND SWAGE STUD

316 STAINLESS STEEL

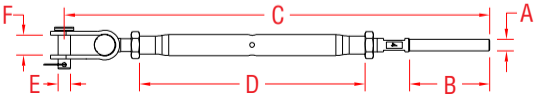

ITEM

A

B

C

D

E

F

WT

(wire)

(lb)

S0782-H0703

1/8"

1.51"

8.02"

4.25"

0.24"

0.38"

0.21

S0782-H0705

3/16"

2.01"

8.64"

4.25"

0.24"

0.38"

0.24

NOTE:

DESIGNED FOR HAND SWAGE USE ONLY. THIS TURNBUCKLE FEATURES A CLOSED STYLE BODY WITH PRECISION MANUFACTURED END FITTINGS. ALL COMPONENTS ARE MADE FROM GRADE 316 STAINLESS STEEL.

CRIMP THE HAND SWAGE STUD ONTO THE WIRE ROPE USING THE HAND SWAGER (PART # E0113-H600, PAGE 42). USE HAND SWAGER HOLE #1 ON 1/8" WIRE AND HOLE #2 ON 3/16" WIRE.

HAND SWAGE