

WALL MOUNT & HAND SWAGE STUD

CHROMED BRONZE BODY & STAINLESS ENDS

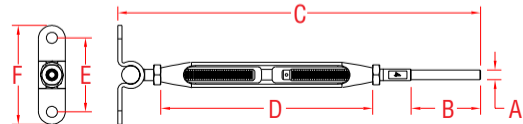

ITEM	A	B	C	D	E	F	WT
S0798-H0703	(wire) 1/8"	1.51"	7.90"	4.61"	1.62"	2.16"	(lb) 0.24
S0798-H0705	3/16"	2.01"	8.52"	4.61"	1.62"	2.16"	0.26

NOTE:

DESIGNED FOR HAND SWAGE USE ONLY. MAKE INSTALLATION PAINLESS, USING SUNCOR'S HAND SWAGE LINE OF FITTINGS. THE OPEN BODY TURNBUCKLE COMBINES CHROMED BRONZE WITH GRADE 316 STAINLESS STEEL. ALSO AVAILABLE WITH SILICON BRONZE BODY.

CRIMP THE HAND SWAGE STUD ONTO THE WIRE ROPE USING THE HAND SWAGER (PART # E0113-H600, PAGE 42). USE HAND SWAGER HOLE #1 ON 1/8" WIRE AND HOLE #2 ON 3/16" WIRE.

REFERENCE "FASTENER MATCHING CHART" (PAGE 156-157) FOR COMPATIBLE FASTENERS.

HAND SWAGE