

BOW SHACKLE WITH BOLT

316 STAINLESS STEEL



Import



Drop Forged



Load Rated



New Product

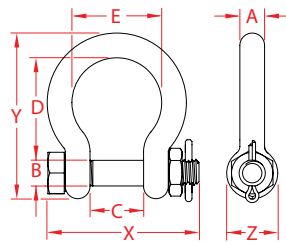

ITEM	A (size)	B	C	D	E	X (height)	Y (length)	Z (width)	WLL (lb)	WT (lb)	PACKAGING TYPE	EACH (qty)	INNER (qty)	CARTON (qty)	UPC
S0119-SA06	1/4"	0.23"	0.52"	0.93"	0.83"	1.37"	1.50"	0.47"	750	0.06	POLYBAG	1	25	300	791506093961
S0119-SA08	5/16"	0.31"	0.66"	1.25"	1.11"	1.77"	2.05"	0.62"	1,200	0.14	POLYBAG	1	25	200	791506093978
S0119-SA10	3/8"	0.39"	0.83"	1.57"	1.28"	2.20"	2.52"	0.78"	2,000	0.26	POLYBAG	1	10	100	791506093985
S0119-SA12	15/32"	0.47"	0.98"	1.94"	1.50"	2.63"	3.07"	0.94"	3,000	0.46	POLYBAG	1	5	50	791506093992
S0119-SA16	5/8"	0.62"	1.31"	2.49"	2.20"	3.40"	3.93"	1.20"	4,000	1.09	POLYBAG	1	5	25	791506094005
S0119-SA20	3/4"	0.77"	1.62"	3.10"	2.55"	4.30"	5.13"	1.57"	5,500	2.31	POLYBAG	1	1	10	791506094012

NOTE:

BOLT DIAMETER MATCHES THE SHACKLE BODY DIAMETER.

ALL DIMENSIONS ARE NOMINAL (+/- 3%) AND ARE SUBJECT TO CHANGE WITHOUT NOTICE.