



# SA BOW SHACKLE BLOCK - ROPE

## 316 STAINLESS STEEL



Import



Precision  
Cast



Stamped



Drop  
Forged



Suncor  
Exclusive



New  
Product

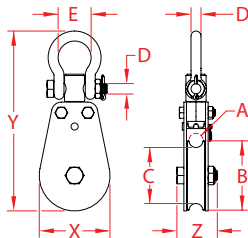

ITEM	A (rope size)	B (sheave dia.)	C	D	E	X (height)	Y (length)	Z (width)	WLL (lb)	WT (lb)	PACKAGING TYPE	EACH (qty)	INNER (qty)	CARTON (qty)	UPC
<b>BRONZE BUSHING</b>															
S0429-12050-BA1	7/16"	2.00"	1.65"	5/16" (8mm)	1.11"	2.04"	5.34"	1.15"	1,000	0.82	POLYBAG	1	1	1	791506090847
S0429-13063-BA1	1/2"	2.50"	2.05"	3/8" (10mm)	1.28"	2.56"	6.51"	1.48"	1,500	1.61	POLYBAG	1	1	1	791506090892
S0429-16079-BA1	5/8"	3.13"	2.53"	15/32" (12mm)	1.50"	3.20"	8.11"	1.80"	3,000	2.88	POLYBAG	1	1	1	791506090946
S0429-20095-BA1	3/4"	3.75"	3.02"	5/8" (16mm)	2.20"	3.80"	9.89"	2.20"	4,000	5.27	POLYBAG	1	1	1	791506090991
S0429-25125-BA1	1"	5.00"	4.00"	3/4" (20mm)	2.55"	5.10"	12.83"	2.78"	5,500	11.48	POLYBAG	1	1	1	791506091042
<b>STAINLESS BEARING</b>															
S0430-12050-BA1	7/16"	2.00"	1.65"	5/16" (8mm)	1.11"	2.04"	5.34"	1.15"	1,000	0.83	POLYBAG	1	1	1	791506091080
S0430-13063-BA1	1/2"	2.50"	2.05"	3/8" (10mm)	1.28"	2.56"	6.51"	1.48"	1,500	1.56	POLYBAG	1	1	1	791506091134
S0430-16079-BA1	5/8"	3.13"	2.53"	15/32" (12mm)	1.50"	3.20"	8.11"	1.80"	3,000	2.82	POLYBAG	1	1	1	791506091189
S0430-20095-BA1	3/4"	3.75"	3.02"	5/8" (16mm)	2.20"	3.80"	9.89"	2.20"	4,000	5.17	POLYBAG	1	1	1	791506091233
S0430-25125-BA1	1"	5.00"	4.03"	3/4" (20mm)	2.55"	5.10"	12.83"	2.78"	5,500	11.25	POLYBAG	1	1	1	791506091288

**NOTE:**  
**MEETS B30.26 SPECIFICATIONS.**  
**ALL DIMENSIONS ARE NOMINAL (+/- 3%) AND ARE SUBJECT TO CHANGE WITHOUT NOTICE.**