



SA BOW SHACKLE BLOCK LoLOAD - WIRE

316 STAINLESS STEEL



Import



Precision
Cast



Stamped



Drop
Forged



Suncor
Exclusive



New
Product

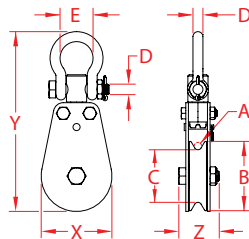

ITEM	A (wire size)	B (sheave dia.)	C	D	E	X (height)	Y (length)	Z (width)	WLL (lb)	WT (lb)	PACKAGING TYPE	EACH (qty)	INNER (qty)	CARTON (qty)	UPC
BRONZE BUSHING															
S0431-05050-BA1	3/16"	2.00"	1.50"	5/16" (8mm)	1.11"	2.04"	5.34"	1.15"	1,000	0.78	POLYBAG	1	1	1	791506091325
S0431-07063-BA1	1/4"	2.50"	1.90"	3/8" (10mm)	1.28"	2.56"	6.51"	1.48"	1,500	1.62	POLYBAG	1	1	1	791506091370
S0431-08078-BA1	5/16"	3.13"	2.33"	3/8" (10mm)	1.28"	3.20"	8.11"	1.80"	2,000	2.98	POLYBAG	1	1	1	791506091424
S0431-10100-BA1	3/8"	4.00"	3.04"	15/32" (12mm)	1.50"	4.06"	8.80"	1.80"	3,000	3.68	POLYBAG	1	1	1	791506091479
STAINLESS BEARING															
S0432-05050-BA1	3/16"	2.00"	1.50"	5/16" (8mm)	1.11"	2.04"	5.31"	1.15"	1,000	0.81	POLYBAG	1	1	1	791506091523
S0432-07063-BA1	1/4"	2.50"	1.90"	3/8" (10mm)	1.28"	2.56"	6.51"	1.48"	1,500	1.59	POLYBAG	1	1	1	791506091578
S0432-08078-BA1	5/16"	3.13"	2.33"	3/8" (10mm)	1.28"	3.20"	8.11"	1.80"	2,000	2.91	POLYBAG	1	1	1	791506091622
S0432-10100-BA1	3/8"	4.00"	3.04"	15/32" (12mm)	1.50"	4.06"	8.80"	1.80"	3,000	3.70	POLYBAG	1	1	1	791506091677

NOTE:
MEETS B30.26 SPECIFICATIONS.
ALL DIMENSIONS ARE NOMINAL (+/- 3%) AND ARE SUBJECT TO CHANGE WITHOUT NOTICE.