



D SHACKLE BLOCK LoLOAD - WIRE

316 STAINLESS STEEL



Import



Precision
Cast



Stamped



Drop
Forged



Suncor
Exclusive



New
Product

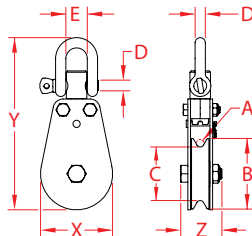

ITEM	A (wire size)	B (sheave dia.)	C	D	E	X (height)	Y (length)	Z (width)	WLL (lb)	WT (lb)	PACKAGING TYPE	EACH (qty)	INNER (qty)	CARTON (qty)	UPC
BRONZE BUSHING															
S0431-05050-DS1	3/16"	2.00"	1.50"	5/16" (8mm)	0.66"	2.04"	5.17"	1.15"	1,000	0.77	POLYBAG	1	1	1	791506091318
S0431-07063-DS1	1/4"	2.50"	1.90"	3/8" (10mm)	0.83"	2.56"	6.11"	1.48"	1,500	1.55	POLYBAG	1	1	1	791506091363
S0431-08078-DS1	5/16"	3.13"	2.33"	3/8" (10mm)	0.83"	3.20"	7.61"	1.80"	2,000	2.94	POLYBAG	1	1	1	791506091417
S0431-10100-DS1	3/8"	4.00"	3.04"	15/32" (12mm)	0.98"	4.06"	8.35"	1.80"	3,000	3.64	POLYBAG	1	1	1	791506091462
STAINLESS BEARING															
S0432-05050-DS1	3/16"	2.00"	1.50"	5/16" (8mm)	0.66"	2.04"	5.17"	1.15"	1,000	0.80	POLYBAG	1	1	1	791506091516
S0432-07063-DS1	1/4"	2.50"	1.90"	3/8" (10mm)	0.83"	2.56"	6.11"	1.48"	1,500	1.52	POLYBAG	1	1	1	791506091561
S0432-08078-DS1	5/16"	3.13"	2.33"	3/8" (10mm)	0.83"	3.20"	7.61"	1.80"	2,000	2.87	POLYBAG	1	1	1	791506091615
S0432-10100-DS1	3/8"	4.00"	3.04"	15/32" (12mm)	0.98"	4.06"	8.35"	1.80"	3,000	3.66	POLYBAG	1	1	1	791506091660

NOTE:
MEETS B30.26 SPECIFICATIONS.
ALL DIMENSIONS ARE NOMINAL (+/- 3%) AND ARE SUBJECT TO CHANGE WITHOUT NOTICE.