

# QA™ STUD & WALL MOUNT

## 316 STAINLESS STEEL

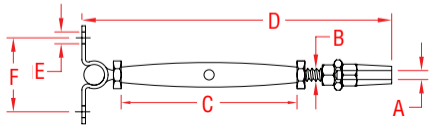

ITEM

A

B

C

D

E

F

WT

(wire size) (thread)

(lb)

S0766-0703

1/8"

1/4"

4.20"

6.75"

0.25"

1.58"

0.25

S0766-0704

5/32"

1/4"

4.20"

6.75"

0.25"

1.58"

0.27

S0766-0905

3/16"

5/16"

4.40"

7.30"

0.31"

2.00"

0.50

S0766-1007

1/4"

3/8"

4.90"

8.00"

0.38"

2.00"

0.74

**NOTE:**

**MECHANICAL SWAGE FITTING ALLOWS VERY FAST ATTACHMENT TO ANY TYPE OF CABLE (1X19, 7X19, OR 7X7) USING ONLY SIMPLE TOOLS. WORKING LOAD LIMIT OF QUICK ATTACH™ FITTINGS ARE 75% OF THE WLL OF WIRE USED.**

**REFERENCE "FASTENER MATCHING CHART" (PAGE 164) FOR COMPATIBLE FASTENERS.**