

QUICK ATTACH™ STUD, UNF LEFT HAND 316 STAINLESS STEEL

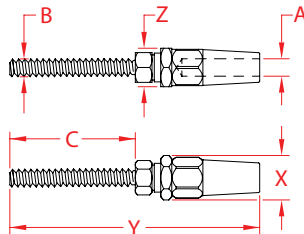

Import



Precision
Machined



Suncor
Exclusive

ITEM	A (wire size)	B (thread)	C	X (height)	Y (length)	Z (width)	WT (lb)	PACKAGING TYPE	EACH (qty)	INNER (qty)	CARTON (qty)	UPC
S0772-0703	1/8"	1/4"	1.85"	0.56"	3.35"	0.50"	0.11	POLYBAG	1	5	200	791506051657
S0772-0704	5/32"	1/4"	1.85"	0.62"	3.65"	0.55"	0.13	POLYBAG	1	5	200	791506051664
S0772-0904	5/32"	5/16"	2.25"	0.62"	4.10"	0.55"	0.15	POLYBAG	1	5	200	791506051671
S0772-0905	3/16"	5/16"	2.25"	0.75"	4.35"	0.66"	0.21	POLYBAG	1	5	175	791506051688
S0772-1005	3/16"	3/8"	2.50"	0.75"	4.52"	0.66"	0.23	POLYBAG	1	5	100	791506051695
S0772-1007	1/4"	3/8"	2.50"	0.88"	4.95"	0.78"	0.33	POLYBAG	1	5	100	791506051701
S0772-1307	1/4"	1/2"	3.15"	0.88"	5.60"	0.78"	0.39	POLYBAG	1	1	75	791506051718
S0772-1309	5/16"	1/2"	3.15"	1.05"	6.25"	0.94"	0.63	POLYBAG	1	1	50	791506051725
S0772-1610	3/8"	5/8"	3.94"	1.18"	7.44"	1.05"	0.95	POLYBAG	1	1	25	791506051749
S0772-2013	1/2"	3/4"	4.72"	1.42"	9.00"	1.25"	1.64	POLYBAG	1	1	20	791506051756

NOTE:

MECHANICAL SWAGE FITTING ALLOWS VERY FAST ATTACHMENT TO ANY TYPE OF CABLE (1X19, 7X19, OR 7X7) USING ONLY SIMPLE TOOLS.

WORKING LOAD LIMIT OF QUICK ATTACH™ FITTINGS ARE 75% OF THE WLL OF WIRE USED.

ALL DIMENSIONS ARE NOMINAL (+/- 3%) AND ARE SUBJECT TO CHANGE WITHOUT NOTICE.