



# ROPE SHEAVE, BUSHING

## 316 STAINLESS STEEL / BRONZE



Import



Precision  
Cast



Suncor  
Exclusive



New  
Product

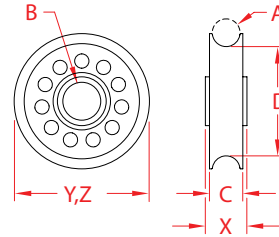

ITEM	A (rope size)	B	C	D	X (height)	Y (length)	Z (width)	SPACER (part #)	WLL (lb)	WT (lb)
S0414-1207*	3/8"-7/16"	0.25"	0.51"	1.65"	0.59"	2.00"	2.00"	S0429-071015	1,000	0.23
S0414-1210	3/8"-7/16"	0.38"	0.51"	1.65"	0.56"	2.00"	2.00"	N/A	1,000	0.22
S0414-1308*	1/2"	0.31"	0.63"	2.05"	0.71"	2.50"	2.50"	S0429-081618	1,500	0.50
S0414-1310*	1/2"	0.38"	0.63"	2.05"	0.71"	2.50"	2.50"	S0429-101618	1,500	0.49
S0414-1313*	1/2"	0.50"	0.63"	2.05"	0.71"	2.50"	2.50"	S0429-131618	1,500	0.47
S0414-1316	1/2"	0.63"	0.63"	2.05"	0.69"	2.50"	2.50"	N/A	1,500	0.45
S0414-1613*	5/8"	0.50"	0.77"	2.53"	0.86"	3.13"	3.13"	S0429-132222	3,000	0.73
S0414-1616*	5/8"	0.63"	0.77"	2.53"	0.86"	3.13"	3.13"	S0429-162222	3,000	0.70
S0414-1620*	5/8"	0.75"	0.77"	2.53"	0.86"	3.13"	3.13"	S0429-202222	3,000	0.67
S0414-1622	5/8"	0.88"	0.77"	2.53"	0.84"	3.13"	3.13"	N/A	3,000	0.63
S0414-2016*	3/4"	0.63"	0.92"	3.02"	1.02"	3.75"	3.75"	S0429-162825	4,000	1.22
S0414-2020*	3/4"	0.75"	0.92"	3.02"	1.02"	3.75"	3.75"	S0429-202825	4,000	1.18
S0414-2022*	3/4"	0.88"	0.92"	3.02"	1.02"	3.75"	3.75"	S0429-222825	4,000	1.13
S0414-2028	3/4"	1.13"	0.92"	3.02"	1.00"	3.75"	3.75"	N/A	4,000	1.02
S0414-2520*	1"	0.75"	1.26"	4.00"	1.40"	5.00"	5.00"	S0429-203135	5,500	2.90
S0414-2522*	1"	0.88"	1.26"	4.00"	1.40"	5.00"	5.00"	S0429-223135	5,500	2.84
S0414-2525*	1"	1.00"	1.26"	4.00"	1.40"	5.00"	5.00"	S0429-253135	5,500	2.76
S0414-2532	1"	1.25"	1.26"	4.00"	1.38"	5.00"	5.00"	N/A	5,500	2.59

**\*INCLUDES SPACER**

**NOTE: ALL DIMENSIONS ARE NOMINAL (+/- 3%) AND ARE SUBJECT TO CHANGE WITHOUT NOTICE.**