



# LoLOAD WIRE ROPE SHEAVE, BUSHING

## 316 STAINLESS STEEL / BRONZE



Import



Precision  
Cast



Suncor  
Exclusive



New  
Product

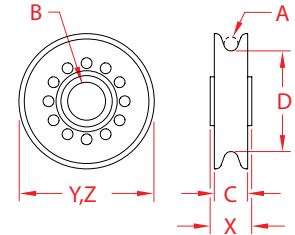

ITEM	A (wire size)	B	C	D	X (height)	Y (length)	Z (width)	SPACER (part #)	WLL (lb)	WT (lb)
S0416-0507*	3/16"	0.25"	0.51"	1.50"	0.59"	2.00"	2.00"	S0429-071015	1,000	0.21
S0416-0510	3/16"	0.38"	0.51"	1.50"	0.56"	2.00"	2.00"	N/A	1,000	0.20
S0416-0710*	1/4"	0.38"	0.63"	1.90"	0.71"	2.50"	2.50"	S0429-101618	1,500	0.50
S0416-0713*	1/4"	0.50"	0.63"	1.90"	0.71"	2.50"	2.50"	S0429-131618	1,500	0.48
S0416-0716	1/4"	0.63"	0.63"	1.90"	0.69"	2.50"	2.50"	N/A	1,500	0.46
S0416-0813*	5/16"	0.50"	0.77"	2.33"	0.86"	3.13"	3.13"	S0429-132222	2,000	0.83
S0416-0816*	5/16"	0.63"	0.77"	2.33"	0.86"	3.13"	3.13"	S0429-162222	2,000	0.80
S0416-0820*	5/16"	0.75"	0.77"	2.33"	0.86"	3.13"	3.13"	S0429-202222	2,000	0.77
S0416-0822	5/16"	0.88"	0.77"	2.33"	0.84"	3.13"	3.13"	N/A	2,000	0.73
S0416-1013*	3/8"	0.50"	0.77"	3.04"	0.86"	4.00"	4.00"	S0429-132222	3,000	1.25
S0416-1016*	3/8"	0.63"	0.77"	3.04"	0.86"	4.00"	4.00"	S0429-162222	3,000	1.22
S0416-1020*	3/8"	0.75"	0.77"	3.04"	0.86"	4.00"	4.00"	S0429-202222	3,000	1.19
S0416-1022	3/8"	0.88"	0.77"	3.04"	0.84"	4.00"	4.00"	N/A	3,000	1.15

**\*INCLUDES SPACER**

**NOTE: ALL DIMENSIONS ARE NOMINAL (+/- 3%) AND ARE SUBJECT TO CHANGE WITHOUT NOTICE.**