



BOLT HEAD BLOCK - ROPE

316 STAINLESS STEEL



Import



Precision
Cast



Stamped



Precision
Machined



Suncor
Exclusive



New
Product

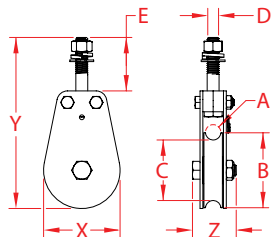

ITEM	A (rope size)	B (sheave dia.)	C	D (thread)	E	X (height)	Y (length)	Z (width)	WLL (lb)	WT (lb)	PACKAGING TYPE	EACH (qty)	INNER (qty)	CARTON (qty)	UPC
BRONZE BUSHING															
S0429-12050-BH1	7/16"	2.00"	1.65"	5/16"-18	1.51"	2.04"	4.75"	1.15"	1,000	0.65	POLYBAG	1	1	1	791506090854
S0429-13063-BH1	1/2"	2.50"	2.05"	3/8"-16	1.35"	2.56"	5.27"	1.48"	1,500	1.27	POLYBAG	1	1	1	791506090908
S0429-16079-BH1	5/8"	3.13"	2.53"	1/2"-13	2.23"	3.20"	7.10"	1.80"	3,000	2.39	POLYBAG	1	1	1	791506090953
S0429-20095-BH1	3/4"	3.75"	3.02"	5/8"-11	2.53"	3.80"	8.43"	2.20"	4,000	4.03	POLYBAG	1	1	1	791506091004
S0429-25125-BH1	1"	5.00"	4.00"	3/4"-10	2.27"	5.10"	9.98"	2.78"	5,500	9.28	POLYBAG	1	1	1	791506091059
STAINLESS BEARING															
S0430-12050-BH1	7/16"	2.00"	1.65"	5/16"-18	1.51"	2.04"	4.75"	1.15"	1,000	0.66	POLYBAG	1	1	1	791506091097
S0430-13063-BH1	1/2"	2.50"	2.05"	3/8"-16	1.35"	2.56"	5.27"	1.48"	1,500	1.22	POLYBAG	1	1	1	791506091141
S0430-16079-BH1	5/8"	3.13"	2.53"	1/2"-13	2.23"	3.20"	7.10"	1.80"	3,000	2.33	POLYBAG	1	1	1	791506091196
S0430-20095-BH1	3/4"	3.75"	3.02"	5/8"-11	2.53"	3.80"	8.43"	2.20"	4,000	3.93	POLYBAG	1	1	1	791506091240
S0430-25125-BH1	1"	5.00"	4.03"	3/4"-10	2.27"	5.10"	9.98"	2.78"	5,500	9.05	POLYBAG	1	1	1	791506091295

NOTE:
MEETS B30.26 SPECIFICATIONS.
ALL DIMENSIONS ARE NOMINAL (+/- 3%) AND ARE SUBJECT TO CHANGE WITHOUT NOTICE.