



# D SHACKLE BLOCK - ROPE

## 316 STAINLESS STEEL



Import



Precision  
Cast



Stamped



Drop  
Forged



Suncor  
Exclusive



New  
Product

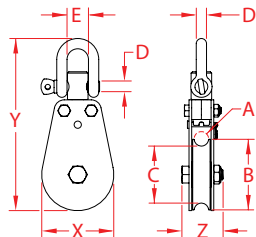

ITEM	A (rope size)	B (sheave dia.)	C	D	E	X (height)	Y (length)	Z (width)	WLL (lb)	WT (lb)	PACKAGING TYPE	EACH (qty)	INNER (qty)	CARTON (qty)	UPC
<b>BRONZE BUSHING</b>															
S0429-12050-DS1	7/16"	2.00"	1.65"	5/16" (8mm)	0.66"	2.04"	5.17"	1.15"	1,000	0.78	POLYBAG	1	1	1	791506090830
S0429-13063-DS1	1/2"	2.50"	2.05"	3/8" (10mm)	0.83"	2.56"	6.11"	1.48"	1,500	1.54	POLYBAG	1	1	1	791506090885
S0429-16079-DS1	5/8"	3.13"	2.53"	15/32" (12mm)	0.98"	3.20"	7.61"	1.80"	3,000	2.84	POLYBAG	1	1	1	791506090939
S0429-20095-DS1	3/4"	3.75"	3.02"	5/8" (16mm)	1.31"	3.80"	9.28"	2.20"	4,000	5.16	POLYBAG	1	1	1	791506090984
S0429-25125-DS1	1"	5.00"	4.00"	3/4" (20mm)	1.62"	5.10"	12.06"	2.78"	5,500	11.31	POLYBAG	1	1	1	791506091035
<b>STAINLESS BEARING</b>															
S0430-12050-DS1	7/16"	2.00"	1.65"	5/16" (8mm)	0.66"	2.04"	5.17"	1.15"	1,000	0.82	POLYBAG	1	1	1	791506091073
S0430-13063-DS1	1/2"	2.50"	2.05"	3/8" (10mm)	0.83"	2.56"	6.11"	1.48"	1,500	1.49	POLYBAG	1	1	1	791506091127
S0430-16079-DS1	5/8"	3.13"	2.53"	15/32" (12mm)	0.98"	3.20"	7.61"	1.80"	3,000	2.78	POLYBAG	1	1	1	791506091172
S0430-20095-DS1	3/4"	3.75"	3.02"	5/8" (16mm)	1.31"	3.80"	9.28"	2.20"	4,000	5.06	POLYBAG	1	1	1	791506091226
S0430-25125-DS1	1"	5.00"	4.03"	3/4" (20mm)	1.62"	5.10"	12.06"	2.78"	5,500	11.08	POLYBAG	1	1	1	791506091271

**NOTE:**  
**MEETS B30.26 SPECIFICATIONS.**  
**ALL DIMENSIONS ARE NOMINAL (+/- 3%) AND ARE SUBJECT TO CHANGE WITHOUT NOTICE.**