



D SHACKLE BLOCK LoLOAD - WIRE

316 STAINLESS STEEL



Import



Precision
Cast



Stamped



Drop
Forged



Suncor
Exclusive



New
Product

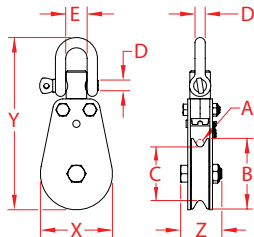

| ITEM | A (wire size) | B (sheave dia.) | C | D | E | X (height) | Y (length) | Z (width) | WLL (lb) | WT (lb) | PACKAGING TYPE | EACH (qty) | INNER (qty) | CARTON (qty) | UPC |
|--------------------------|------------------|--------------------|-------|---------------|-------|---------------|---------------|--------------|-------------|------------|-------------------|---------------|----------------|-----------------|--------------|
| BRONZE BUSHING | | | | | | | | | | | | | | | |
| S0431-05050-DS1 | 3/16" | 2.00" | 1.50" | 5/16" (8mm) | 0.66" | 2.04" | 5.17" | 1.15" | 1,000 | 0.77 | POLYBAG | 1 | 1 | 1 | 791506091318 |
| S0431-07063-DS1 | 1/4" | 2.50" | 1.90" | 3/8" (10mm) | 0.83" | 2.56" | 6.11" | 1.48" | 1,500 | 1.55 | POLYBAG | 1 | 1 | 1 | 791506091363 |
| S0431-08078-DS1 | 5/16" | 3.13" | 2.33" | 3/8" (10mm) | 0.83" | 3.20" | 7.61" | 1.80" | 2,000 | 2.94 | POLYBAG | 1 | 1 | 1 | 791506091417 |
| S0431-10100-DS1 | 3/8" | 4.00" | 3.04" | 15/32" (12mm) | 0.98" | 4.06" | 8.35" | 1.80" | 3,000 | 3.64 | POLYBAG | 1 | 1 | 1 | 791506091462 |
| STAINLESS BEARING | | | | | | | | | | | | | | | |
| S0432-05050-DS1 | 3/16" | 2.00" | 1.50" | 5/16" (8mm) | 0.66" | 2.04" | 5.17" | 1.15" | 1,000 | 0.80 | POLYBAG | 1 | 1 | 1 | 791506091516 |
| S0432-07063-DS1 | 1/4" | 2.50" | 1.90" | 3/8" (10mm) | 0.83" | 2.56" | 6.11" | 1.48" | 1,500 | 1.52 | POLYBAG | 1 | 1 | 1 | 791506091561 |
| S0432-08078-DS1 | 5/16" | 3.13" | 2.33" | 3/8" (10mm) | 0.83" | 3.20" | 7.61" | 1.80" | 2,000 | 2.87 | POLYBAG | 1 | 1 | 1 | 791506091615 |
| S0432-10100-DS1 | 3/8" | 4.00" | 3.04" | 15/32" (12mm) | 0.98" | 4.06" | 8.35" | 1.80" | 3,000 | 3.66 | POLYBAG | 1 | 1 | 1 | 791506091660 |

NOTE:
MEETS B30.26 SPECIFICATIONS.
ALL DIMENSIONS ARE NOMINAL (+/- 3%) AND ARE SUBJECT TO CHANGE WITHOUT NOTICE.