



D SHACKLE BLOCK HILOAD - WIRE

316 STAINLESS STEEL



Import



Precision
Cast



Stamped



Drop
Forged



Suncor
Exclusive



New
Product

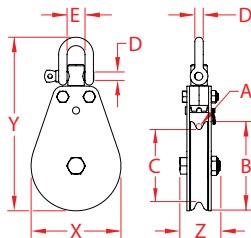

ITEM	A (wire size)	B (sheave dia.)	C	D	E	X (height)	Y (length)	Z (width)	WLL (lb)	WT (lb)	PACKAGING TYPE	EACH (qty)	INNER (qty)	CARTON (qty)	UPC
BRONZE BUSHING															
S0433-03050-DS1*	1/8"	2.00"	1.64"	1/4" (6mm)	0.52"	2.04"	4.33"	0.99"	500	0.48	POLYBAG	1	1	1	791506091714
S0433-05075-DS1	3/16"	3.00"	2.42"	3/8" (10mm)	0.83"	3.06"	6.53"	1.48"	1,500	1.72	POLYBAG	1	1	1	791506091769
S0433-07100-DS1	1/4"	4.00"	3.28"	3/8" (10mm)	0.83"	4.06"	7.84"	1.80"	2,000	3.23	POLYBAG	1	1	1	791506091813
S0433-08125-DS1	5/16"	5.00"	4.20"	15/32" (12mm)	0.98"	5.10"	9.75"	1.80"	3,000	4.49	POLYBAG	1	1	1	791506091868
S0433-10150-DS1	3/8"	6.00"	5.00"	5/8" (16mm)	1.31"	6.10"	11.66"	2.20"	4,000	8.37	POLYBAG	1	1	1	791506091912
STAINLESS BEARING															
S0434-03050-DS1*	1/8"	2.00"	1.64"	1/4" (6mm)	0.52"	2.04"	4.33"	0.99"	500	0.50	POLYBAG	1	1	1	791506091967
S0434-05075-DS1	3/16"	3.00"	2.42"	3/8" (10mm)	0.83"	3.06"	6.53"	1.48"	1,500	1.72	POLYBAG	1	1	1	791506092018
S0434-07100-DS1	1/4"	4.00"	3.28"	3/8" (10mm)	0.83"	4.06"	7.84"	1.80"	2,000	3.18	POLYBAG	1	1	1	791506092063
S0434-08125-DS1	5/16"	5.00"	4.20"	15/32" (12mm)	0.98"	5.10"	9.75"	1.80"	3,000	4.43	POLYBAG	1	1	1	791506092117
S0434-10150-DS1	3/8"	6.00"	5.00"	5/8" (16mm)	1.31"	6.10"	11.66"	2.20"	4,000	8.40	POLYBAG	1	1	1	791506092162

NOTE:
MEETS B30.26 SPECIFICATIONS.
***THIS SIZE BLOCK IS SUPPLIED WITHOUT REMOVABLE CLEVIS PIN/COTTER RING AND FREE SWIVELS ONLY.**
ALL DIMENSIONS ARE NOMINAL (+/- 3%) AND ARE SUBJECT TO CHANGE WITHOUT NOTICE.