

“D” RING

316 STAINLESS STEEL



Import



Wire
Formed

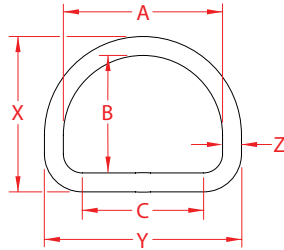

| ITEM | A | B | C (webbing) | X (height) | Y (length) | Z (width) | WLL (lb) | WT (lb) | PACKAGING TYPE | EACH (qty) | INNER (qty) | CARTON (qty) | UPC |
|--------------|-------|-------|----------------|---------------|---------------|--------------|-------------|------------|-------------------|---------------|----------------|-----------------|--------------|
| S0139-X325 | 1.25" | 0.88" | 1.00" | 1.15" | 1.50" | 0.13" | 100 | 0.01 | POLYBAG | 1 | 200 | 3,000 | 791506033271 |
| S0139-X525 | 1.38" | 1.06" | 1.00" | 1.48" | 1.77" | 0.19" | 300 | 0.04 | POLYBAG | 1 | 100 | 1,000 | 791506033288 |
| S0139-X540 | 1.80" | 1.31" | 1.50" | 1.70" | 2.25" | 0.19" | 300 | 0.05 | POLYBAG | 1 | 50 | 750 | 791506033295 |
| S0139-X625 | 1.50" | 1.25" | 1.00" | 1.75" | 2.00" | 0.25" | 500 | 0.06 | POLYBAG | 1 | 50 | 500 | 791506033301 |
| S0139-X640 * | 2.00" | 1.50" | 1.50" | 1.95" | 2.45" | 0.25" | 500 | 0.08 | POLYBAG | 1 | 50 | 500 | 791506033318 |
| S0139-X650 | 2.50" | 1.75" | 2.00" | 2.20" | 2.95" | 0.25" | 500 | 0.10 | POLYBAG | 1 | 50 | 400 | 791506033325 |
| S0139-X850 | 2.60" | 1.94" | 2.00" | 2.56" | 3.29" | 0.31" | 800 | 0.18 | POLYBAG | 1 | 25 | 200 | 791506033332 |
| S0139-X865 | 3.00" | 2.19" | 2.50" | 2.81" | 3.75" | 0.31" | 800 | 0.22 | POLYBAG | 1 | 25 | 200 | 791506033349 |
| S0139-X875 | 3.55" | 2.40" | 3.00" | 3.05" | 4.25" | 0.31" | 800 | 0.24 | POLYBAG | 1 | 25 | 150 | 791506033356 |

NOTE:

MEETS THE REQUIREMENTS OF: MIL-DTL-32655 (*EXCLUDING S0139-X640).

WORKING LOADS ARE BASED ON “C” LENGTH BEING USED IN FULL BY WEBBING, AND NOT UNDER POINT OR SHOCK LOAD.

ALL DIMENSIONS ARE NOMINAL (+/- 3%) AND ARE SUBJECT TO CHANGE WITHOUT NOTICE.