

US BOLT CHAIN SHACKLE WITH OVERSIZE BOLT

316-NM STAINLESS STEEL



Made in
USA



Drop
Forged



Load
Rated



Suncor
Exclusive

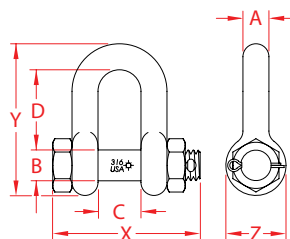

ITEM	A (size)	B	C	D	X (height)	Y (length)	Z (width)	WLL (lb)	WT (lb)	PACKAGING TYPE	EACH (qty)	INNER (qty)	CARTON (qty)	UPC
S0115-SA07-US	1/4"	0.31"	0.46"	0.87"	1.59"	1.55"	0.61"	1,000	0.10	POLYBAG	1	5	200	791506029281
S0115-SA08-US	5/16"	0.38"	0.52"	1.02"	1.80"	1.85"	0.72"	1,300	0.16	POLYBAG	1	5	100	791506029304
S0115-SA10-US	3/8"	0.44"	0.65"	1.24"	2.28"	2.24"	0.90"	1,500	0.30	POLYBAG	1	5	100	791506029328
S0115-SA12-US	7/16"	0.50"	0.75"	1.43"	2.62"	2.62"	1.00"	2,000	0.43	POLYBAG	1	1	50	791506029342
S0115-SA13-US	1/2"	0.63"	0.79"	1.58"	2.87"	2.93"	1.18"	3,000	0.72	POLYBAG	1	1	50	791506029366
S0115-SA16-US	5/8"	0.75"	1.05"	1.94"	3.61"	3.64"	1.45"	4,000	1.31	POLYBAG	1	1	20	791506029380
S0115-SA20-US	3/4"	0.88"	1.20"	2.40"	4.18"	4.40"	1.72"	6,000	2.20	POLYBAG	1	1	15	791506029403
S0115-SA22-US	7/8"	1.01"	1.45"	2.88"	4.84"	5.25"	1.94"	8,000	3.41	POLYBAG	1	1	10	791506029427
S0115-SA25-US	1"	1.13"	1.67"	3.20"	5.18"	5.85"	2.19"	10,000	4.69	POLYBAG	1	1	5	791506029441

NOTE:

I/A/W FED. SPECIFICATION RR-C-271, TYPE IVB, CLASS 3, (EXCEPT 316 STAINLESS STEEL). MEETS THE REQUIREMENTS OF: MIL-DTL-32655.

MEETS ASME B30.26-2010 SECTION 26-0. MARKED TO THE NEAREST FRACTIONAL TON.

ALL DIMENSIONS ARE NOMINAL (+/- 3%) AND ARE SUBJECT TO CHANGE WITHOUT NOTICE.