



NEW SWIVEL HOIST RING SERIES

NEW
PRODUCT
SERIES

PATENTED DESIGN
PAT. US 11,167,957

180°
RING PIVOT

WIDE RING
ACCEPTS
THICK CRANE
HOOKS

**FORGED
316 STAINLESS
STEEL RING**
(AVAILABLE IN
STANDARD OR LONG)

**WLL &
SCREW
TORQUE
ENGRAVED
ON PART**

**WELDED PIN
FOR PERMANENT
ASSEMBLY
TO PREVENT
LOOSENING**



**LOW FRICTION
BRONZE
WASHER**

**ASTM F593
HIGH STRENGTH
SCREW WITH INCH
SIZE UNC THREADS**
(AVAILABLE IN
SHORT OR LONG)

**ALL 316 SS
PRECISION
CNC MACHINED
SWIVEL
COMPONENTS**

360°
ROTATION

SWIVEL HOIST RING - LONG WITH LONG SCREW

316 STAINLESS STEEL

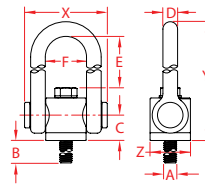
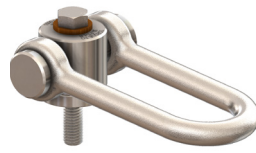

ITEM	A (UNC thread)	B	C	D	E	F	WLL (lb)	X (height)	Y (length)	Z (width)	WT (lb)
S0325-1333L	1/2-13	1.29"	1.07"	0.63"	4.00"	1.81"	1,600	3.65"	6.90"	1.75"	3.10
S0325-1638L	5/8-11	1.47"	1.26"	0.75"	4.33"	2.06"	2,200	4.20"	7.68"	2.00"	4.70
S0325-2045L	3/4-10	1.80"	1.52"	0.88"	4.48"	2.44"	3,200	4.91"	8.61"	2.38"	7.60
S0325-2250L	7/8-9	1.96"	1.73"	1.00"	4.44"	2.81"	4,400	5.64"	9.13"	2.75"	10.90

NOTE: THREADS ARE "UNC". DESIGNED FOR 5:1 SAFETY FACTOR. MEETS ASME.B30.26. REPLACEMENT PARTS AVAILABLE.

SWIVEL HOIST RING - LONG WITH SHORT SCREW

316 STAINLESS STEEL

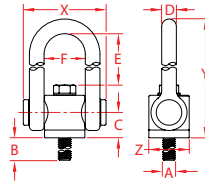
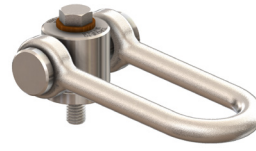

ITEM	A (UNC thread)	B	C	D	E	F	WLL (lb)	X (height)	Y (length)	Z (width)	WT (lb)
S0325-1320L	1/2-13	0.79"	1.07"	0.63"	4.00"	1.81"	1,600	3.65"	6.90"	1.75"	3.10
S0325-1625L	5/8-11	0.97"	1.26"	0.75"	4.33"	2.06"	2,200	4.20"	7.68"	2.00"	4.70
S0325-2032L	3/4-10	1.30"	1.52"	0.88"	4.48"	2.44"	3,200	4.91"	8.61"	2.38"	7.60
S0325-2237L	7/8-9	1.46"	1.73"	1.00"	4.44"	2.81"	4,400	5.64"	9.13"	2.75"	10.90

NOTE: THREADS ARE "UNC". DESIGNED FOR 5:1 SAFETY FACTOR. MEETS ASME.B30.26. REPLACEMENT PARTS AVAILABLE.

SWIVEL HOIST RING - STANDARD WITH LONG SCREW

316 STAINLESS STEEL

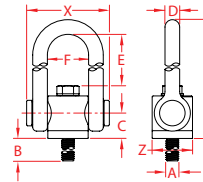
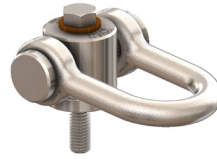

ITEM	A (UNC thread)	B	C	D	E	F	WLL (lb)	X (height)	Y (length)	Z (width)	WT (lb)
S0325-0820S	5/16-18	0.77"	0.68"	0.38"	1.29"	1.04"	600	2.17"	3.10"	1.00"	0.59
S0325-1021S	3/8-16	0.83"	0.77"	0.44"	1.29"	1.30"	800	2.62"	3.39"	1.25"	0.91
S0325-1333S	1/2-13	1.29"	1.07"	0.63"	2.00"	1.81"	1,600	3.65"	4.92"	1.75"	2.70
S0325-1638S	5/8-11	1.47"	1.26"	0.75"	2.26"	2.06"	2,200	4.20"	5.69"	2.00"	4.20
S0325-2045S	3/4-10	1.80"	1.52"	0.88"	2.50"	2.44"	3,200	4.91"	6.59"	2.38"	6.90
S0325-2250S	7/8-9	1.96"	1.73"	1.00"	2.95"	2.81"	4,400	5.64"	7.63"	2.75"	10.30

NOTE: THREADS ARE "UNC". DESIGNED FOR 5:1 SAFETY FACTOR. MEETS ASME.B30.26. REPLACEMENT PARTS AVAILABLE.

SWIVEL HOIST RING - STANDARD WITH SHORT SCREW

316 STAINLESS STEEL

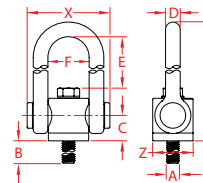

ITEM	A (UNC thread)	B	C	D	E	F	WLL (lb)	X (height)	Y (length)	Z (width)	WT (lb)
S0325-0813S	5/16-18	0.52"	0.68"	0.38"	1.29"	1.04"	600	2.17"	3.10"	1.00"	0.59
S0325-1015S	3/8-16	0.58"	0.77"	0.44"	1.29"	1.30"	800	2.62"	3.39"	1.25"	0.91
S0325-1320S	1/2-13	0.79"	1.07"	0.63"	2.00"	1.81"	1,600	3.65"	4.92"	1.75"	2.70
S0325-1625S	5/8-11	0.97"	1.26"	0.75"	2.26"	2.06"	2,200	4.20"	5.69"	2.00"	4.20
S0325-2032S	3/4-10	1.30"	1.52"	0.88"	2.50"	2.44"	3,200	4.91"	6.59"	2.38"	6.90
S0325-2237S	7/8-9	1.46"	1.73"	1.00"	2.95"	2.81"	4,400	5.64"	7.63"	2.75"	10.30

NOTE: THREADS ARE "UNC". DESIGNED FOR 5:1 SAFETY FACTOR. MEETS ASME.B30.26. REPLACEMENT PARTS AVAILABLE.

NOTE: ALL DIMENSIONS ARE NOMINAL (+/- 3%) AND ARE SUBJECT TO CHANGE WITHOUT NOTICE.